

VXD Clean Room in B4

History:

Old „SVD2 Room“ at the times of Belle

Now:

ARICH room
not (really) needed after
ARICH/ECL installation
which must happen
before April 2016

Proposal:

Use free Clean Room for
the VXD in Phases 2 and 3





ARICH Clean Room Layout

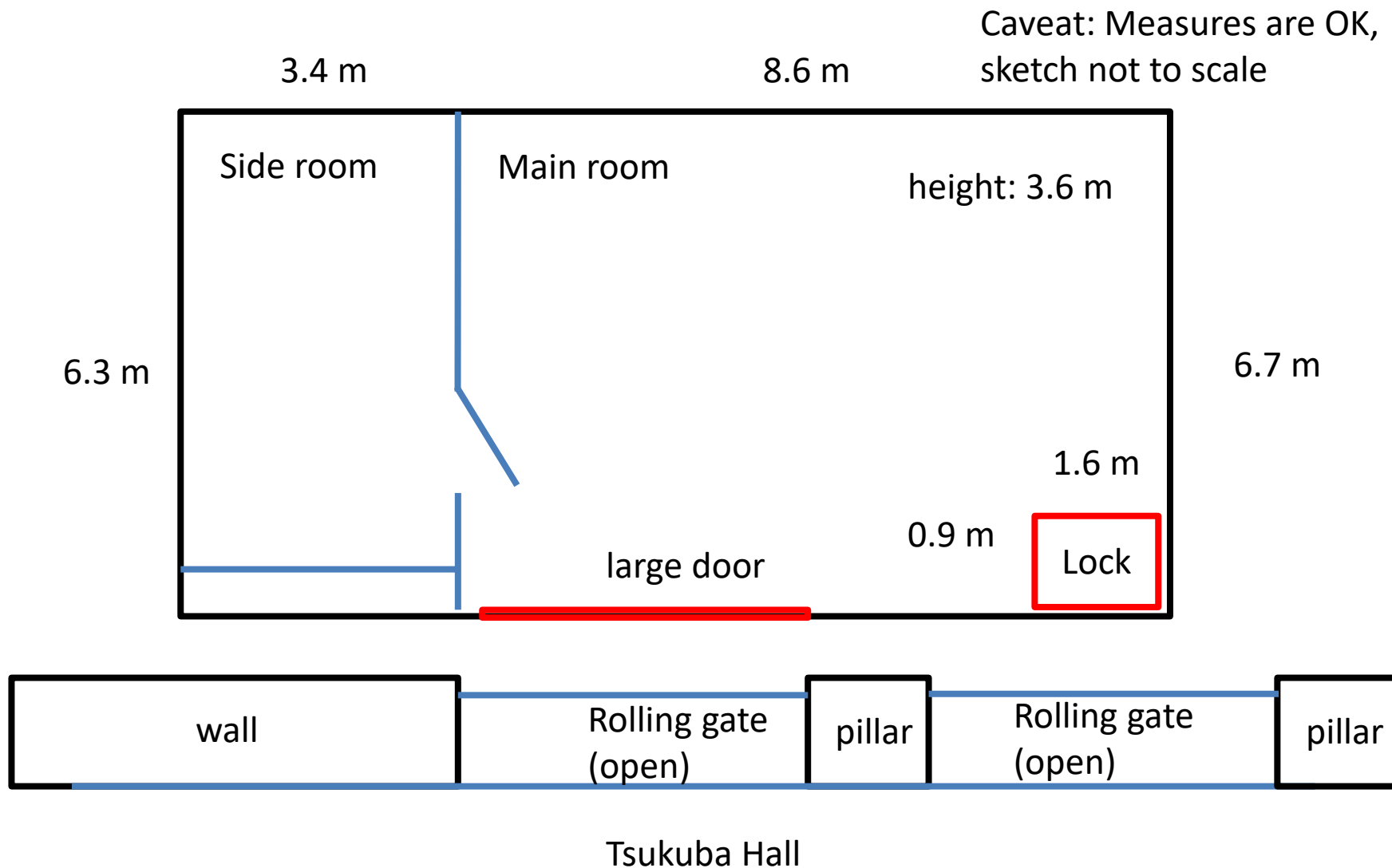

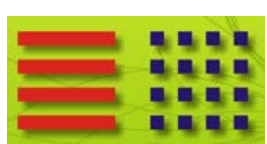

Present Use by ARICH



Main room



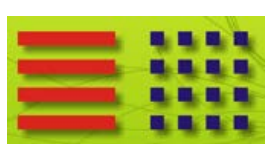

Present Use by ARICH



side room

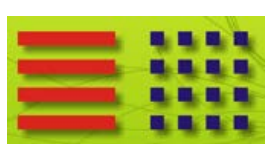

Present Use by ARICH



Free view between main room and side room



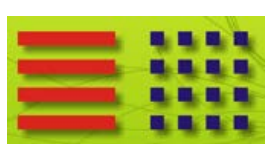

Present Use by ARICH



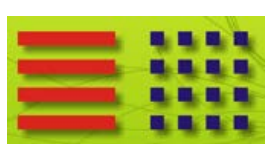

Present Use by ARICH



view towards the side room





Present Use by ARICH





VXD Clean Room Layout

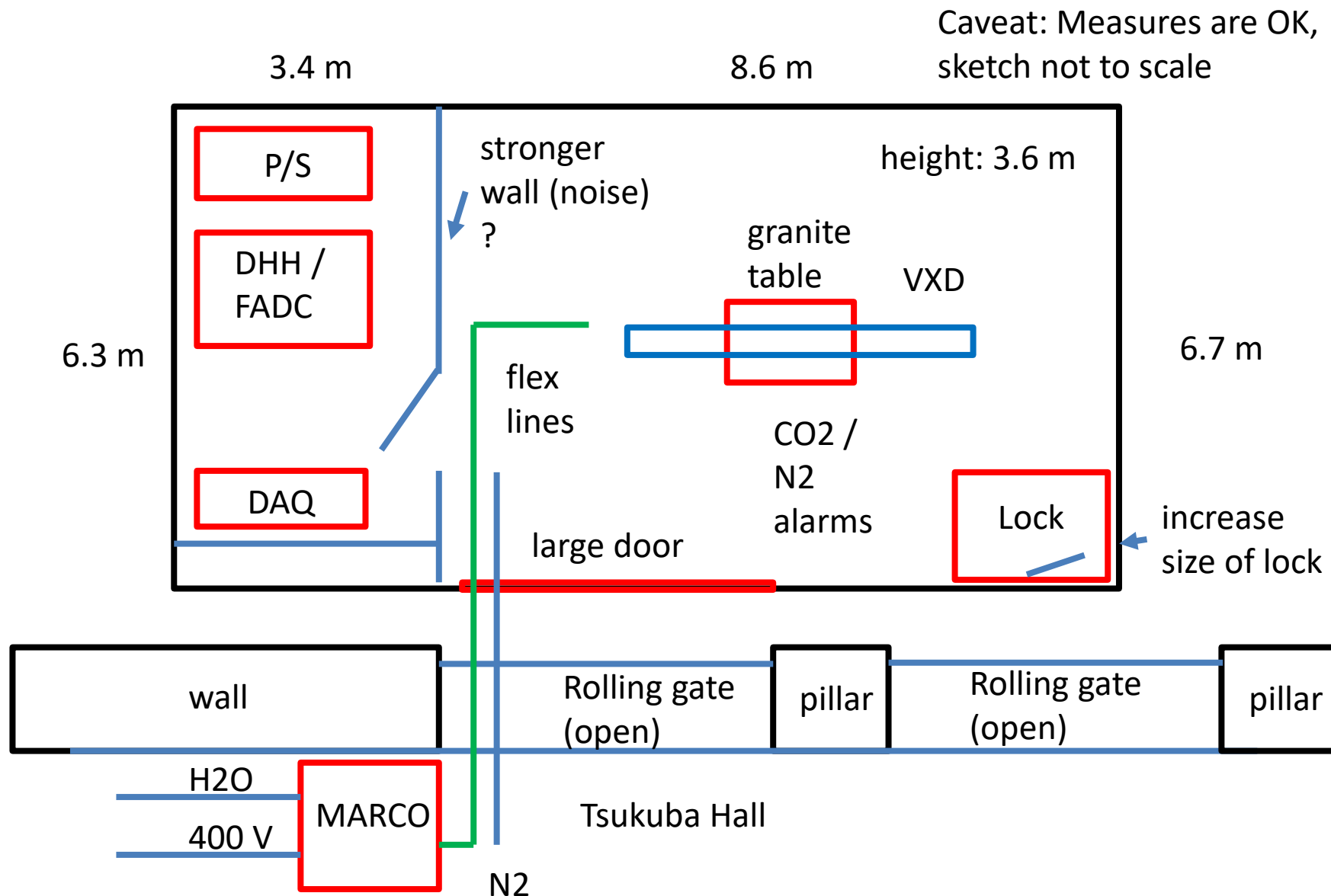



Conclusion



- Many options for the VXD assembly area have been explored
- B1 is excluded
 - needed by SVD
 - too small anyway
 - no possibility connecting to MARCO
- B4 is the natural place
 - First CDC area was considered -> building clean is expensive & difficult
- ARICH room will become available from April 2017 onwards
- Hand-over agreed with ARICH group in principle, April would be OK, BUT: they request possibility to come back with ARICH for potential repair.
- Need to develop a „floor plan“ accomodating both detectors in case of emergency